

GLOUCESTER COUNTY

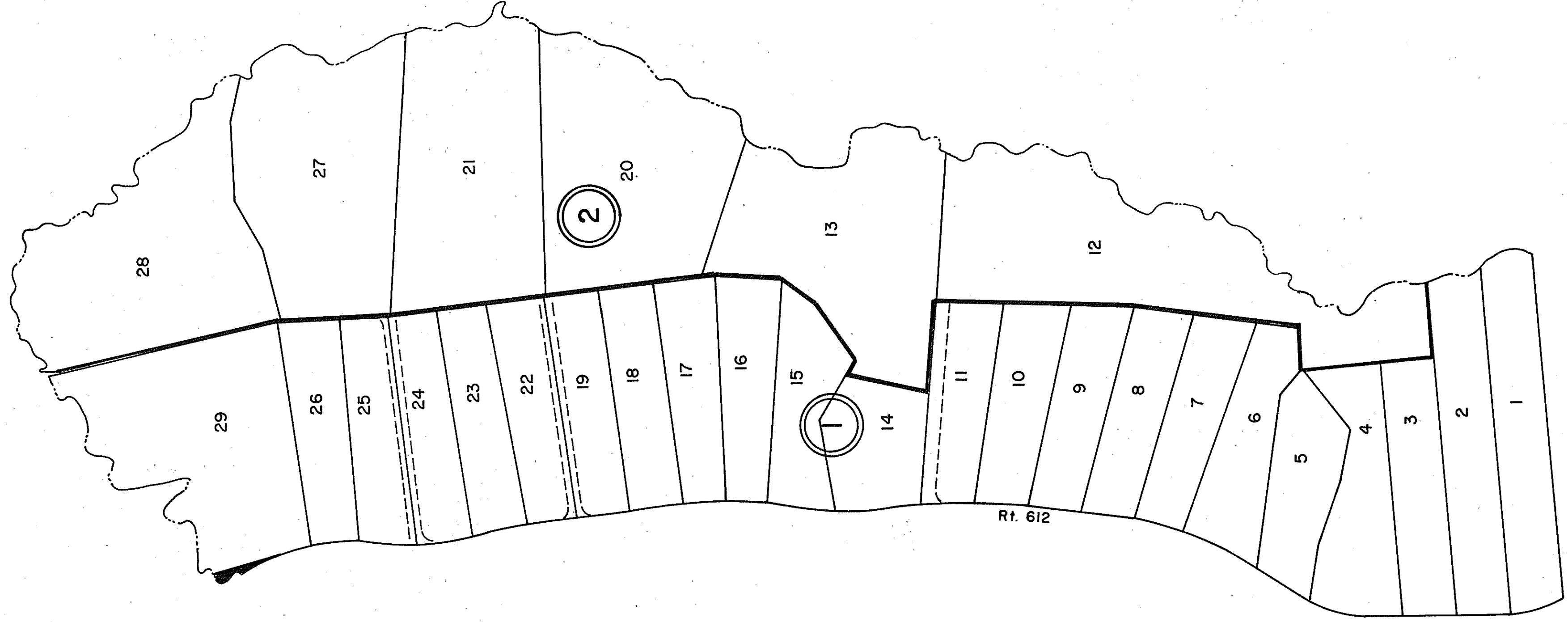

- ① COLONY SUBDIVISION
PARCELS 1-11, 14-19, 22-26 & 29
P.B. 21, Pgs. 226 & 227 10/27/86
NAME CHANGED DB 318-871 4/7/87 (FROM G&H TO COLONY)
LOTS 3&4 REVISED P.B. 21, Pg. 893 12/13/88
- ② COLONY SUBDIVISION
PARCELS 12, 13, 20, 21, 27 & 28
P.B. 21, Pgs. 479 & 480 7/23/87
LOT 12 REVISED P.B. 21, Pg. 893 12/13/88

12/86, 87/88/89/92

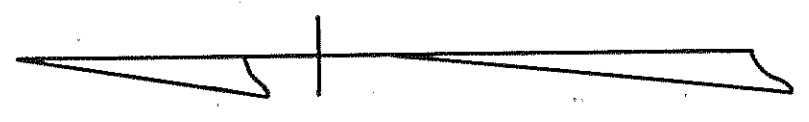
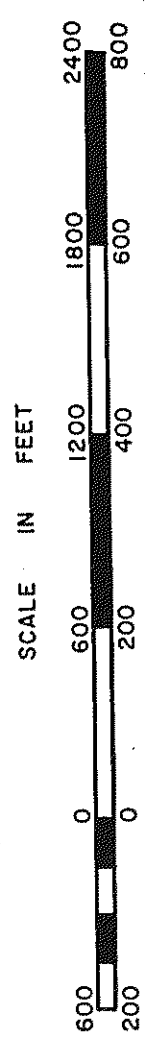

PETSWORTH

DISTRICT

SECTION
INSERT 23D