

GLOUCESTER COUNTY

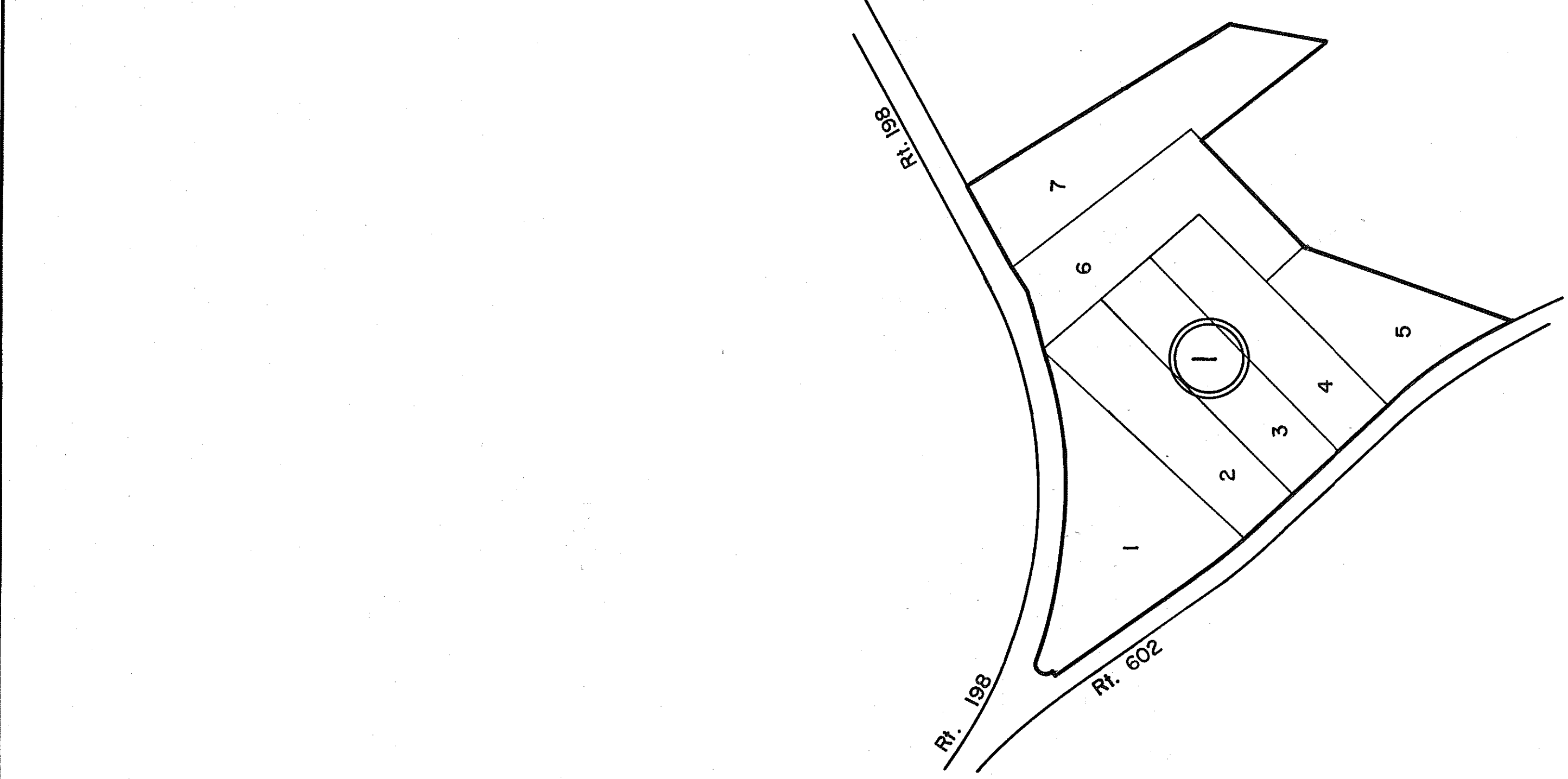

① CALLAHAN VILLAGE - SEC. 1  
LOTS 1-7  
P.B. 22, Pg. 1143-5/26/95

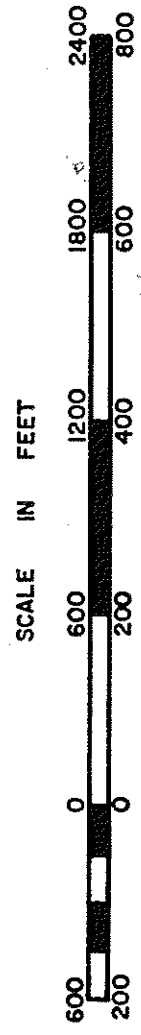

REVISED:

PETSWORTH DISTRICT

PREPARED BY VIRGINIA STATE DEPARTMENT OF TAXATION, DIVISION OF REAL ESTATE APPRAISAL AND MAPPING

SECTION  
INSERT 19E