

# GLOUCESTER COUNTY SURVEY MARK DATA SHEET

**STATION NO.**  
020

HORIZONTAL DATA :		
VA. STATE PLANE COORD. - SOUTH ZONE (NAD 1983)		
UNITS	EASTING (X)	NORTHING (Y)
METERS	3666549.410	1128661.465
U.S. SURVEY FT.	12029337.523	3702950.156
LATITUDE (DMS)		37 28 39.84591
LONGITUDE (DMS)		76 37 0.60148
SCALE FACTOR		0.99994725
CONVERGENCE $\sphericalangle$ (DMS)		1 8 34.59
VERTICAL DATA :		
REF. TO NATL. GEOD. VERT. DATUM (1988)		
UNITS	STATION ELEVATION	
METERS	31.43	
U.S. SURVEY FT.	103.12	

**STATION DESCRIPTION :**

**DISTRICT :** PETSWORTH

A 3-1/4" ALUMINUM DISK MONUMENT SET APPROXIMATELY FLUSH WITH THE GROUND STAMPED STATION NO. 020. TO REACH: MONUMENT IS LOCATED IN THE NORTHWEST QUADRANT OF THE INTERSECTION OF U. S. ROUTE 17 AND STATE ROUTE 610 AT WOODS CROSS ROADS.

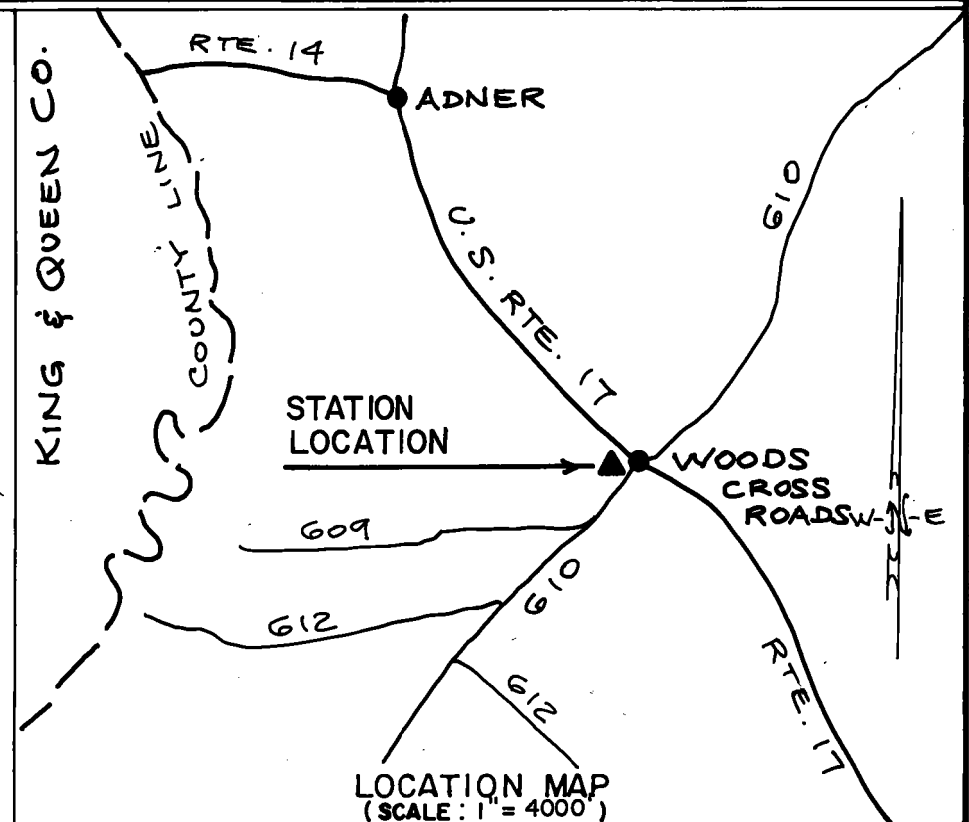
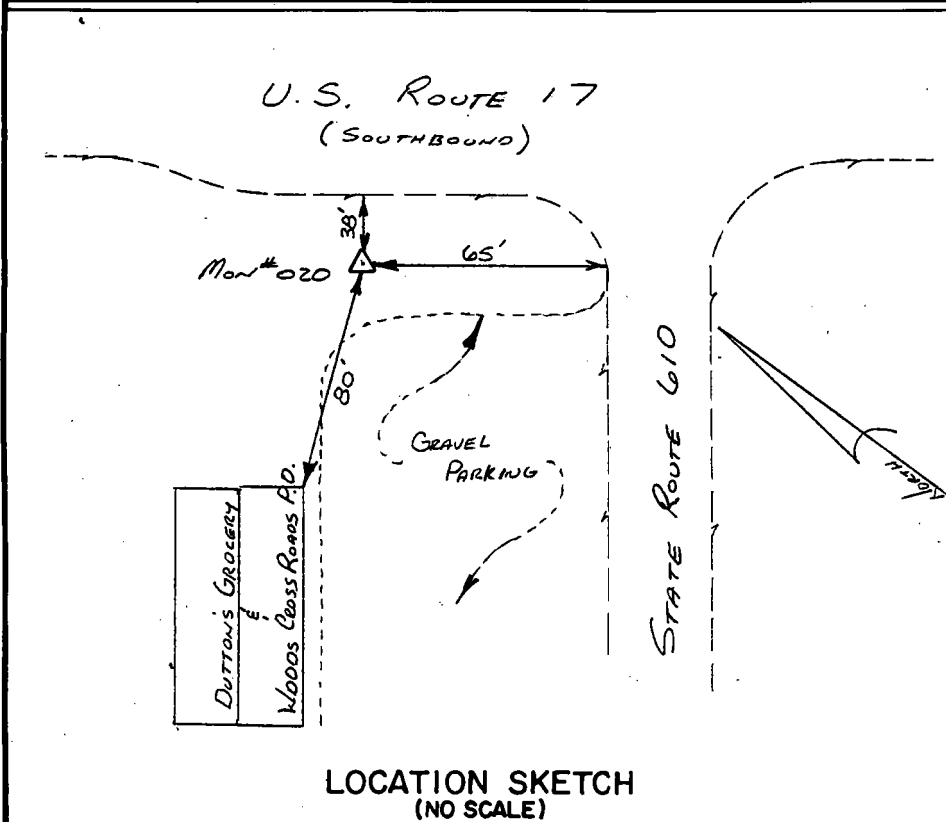

DATE: JANUARY, 1992

NOTE: USERS OF MONUMENTS LOCATED ON PRIVATE PROPERTY  
MUST OBTAIN LAND OWNERS PERMISSION BEFORE ENTERING



**DAWSON & PHILLIPS, P.C.**  
CERTIFIED LAND SURVEYORS  
(804) 693-2993