

GLOUCESTER COUNTY SURVEY MARK DATA SHEET

STATION NO.
038

HORIZONTAL DATA :

VA. STATE PLANE COORD. - SOUTH ZONE (NAD 1983)

UNITS	EASTING (X)	NORTHING (Y)
METERS	3668219.637	1123107.274
U.S. SURVEY FT.	12034817.259	3684727.781
LATITUDE (DMS)	37 25 38.62832	
LONGITUDE (DMS)	76 35 57.18465	
SCALE FACTOR	0.99994595	
CONVERGENCE α (DMS)	1 9 13.07	

STATION DESCRIPTION :

DISTRICT : PETSWORTH

A 3-1/4" ALUMINUM DISK MONUMENT SET APPROXIMATELY FLUSH WITH THE GROUND STAMPED STATION NO. 038. TO REACH: FROM THE INTERSECTION OF STATE ROUTE 606 AND STATE ROUTE 614 AT SASSAFRAS, GO ABOUT 0.93 MILE NORTHEAST ON STATE ROUTE 606 TO INTERSECTION WITH STATE ROUTE 615; GO ABOUT 0.8 MILE NORTH ON STATE ROUTE 615 TO MONUMENT SITE ON EAST SIDE OF STATE ROUTE 615.

VERTICAL DATA :

REF. TO NATL. GEOD. VERT. DATUM (1988)

UNITS	STATION ELEVATION
METERS	27.23
U.S. SURVEY FT.	89.32

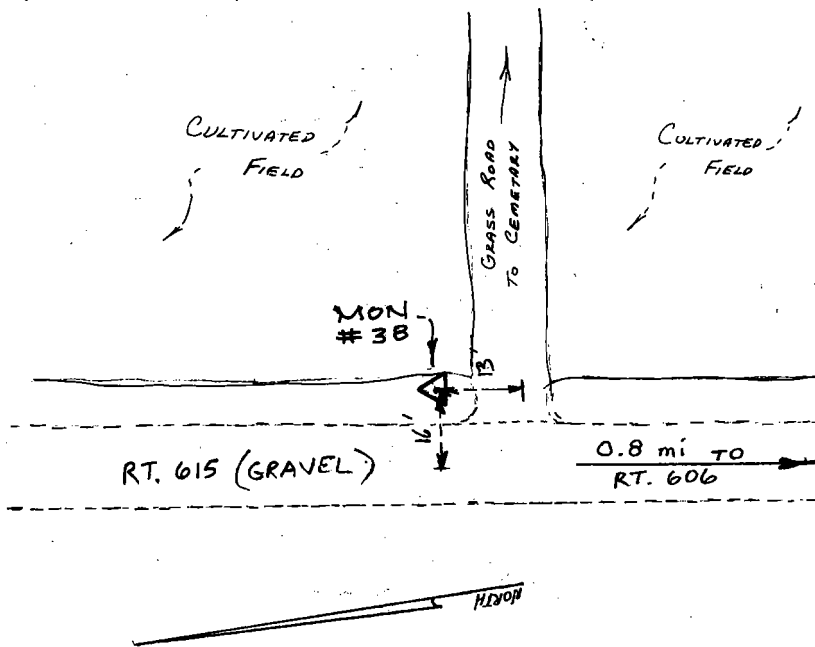

LOCATION SKETCH
(NO SCALE)

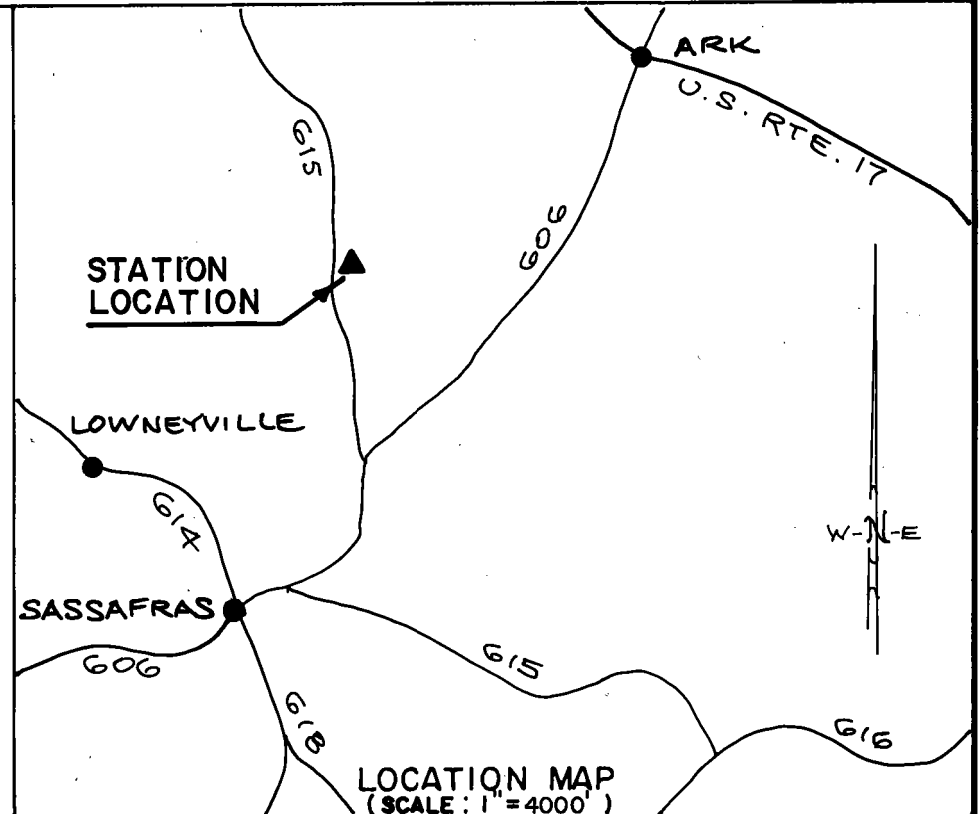

LOCATION MAP
(SCALE: 1"=4000')

DATE: JANUARY, 1992

NOTE: USERS OF MONUMENTS LOCATED ON PRIVATE PROPERTY
MUST OBTAIN LAND OWNERS PERMISSION BEFORE ENTERING



DAWSON & PHILLIPS, P.C.

CERTIFIED LAND SURVEYORS
(804) 683-2993