

# GLOUCESTER COUNTY SURVEY MARK DATA SHEET

**STATION NO.**  
047

HORIZONTAL DATA :		
VA. STATE PLANE COORD. - SOUTH ZONE (NAD 1983)		
UNITS	EASTING (X)	NORTHING (Y)
METERS	3670117.233	1124306.966
U.S. SURVEY FT.	12041042.955	3688663.771
LATITUDE (DMS)		37 26 16.28997
LONGITUDE (DMS)		76 34 39.02203
SCALE FACTOR		0.99994615
CONVERGENCE $\angle$ (DMS)		1 10 0.51
VERTICAL DATA :		
REF. TO NATL. GEOD. VERT. DATUM (1988)		
UNITS	STATION ELEVATION	
METERS	26.10	
U.S. SURVEY FT.	85.61	

**STATION DESCRIPTION :**

**DISTRICT :** PETSWORTH

A 3-1/4" ALUMINUM DISK MONUMENT SET APPROXIMATELY FLUSH WITH THE GROUND STAMPED STATION NO. 047. TO REACH: MONUMENT SITE IS IN THE NORTHWEST QUADRANT OF THE INTERSECTION OF U. S. ROUTE 17 AND STATE ROUTE 606 AT ARK.

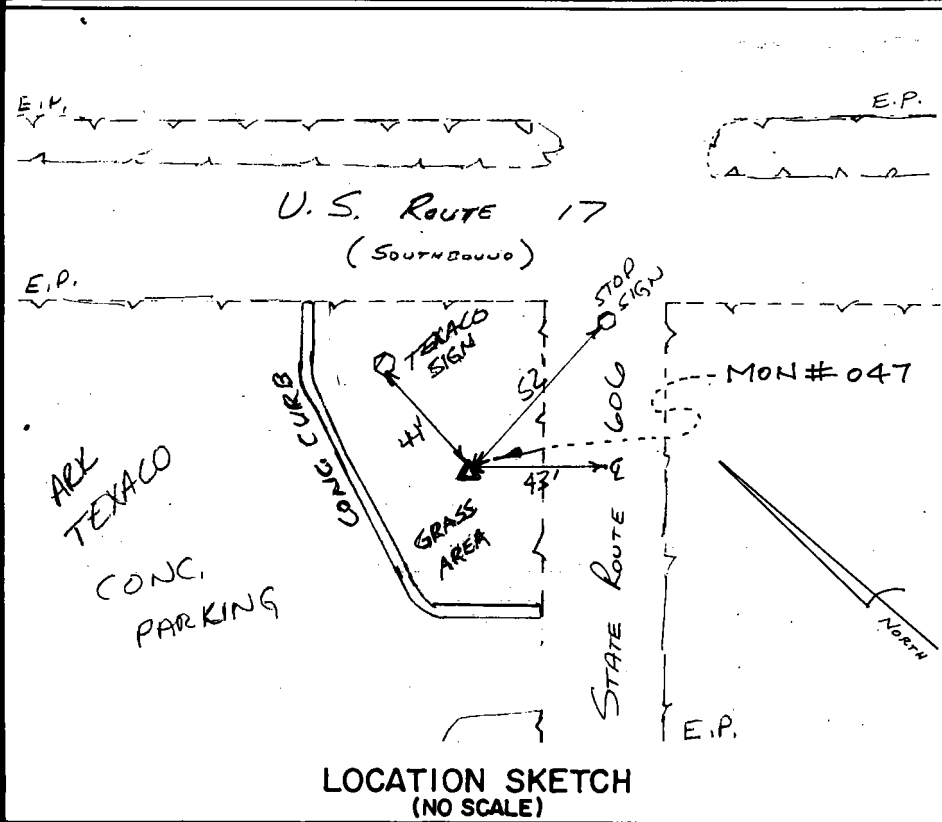

**LOCATION SKETCH**  
(NO SCALE)

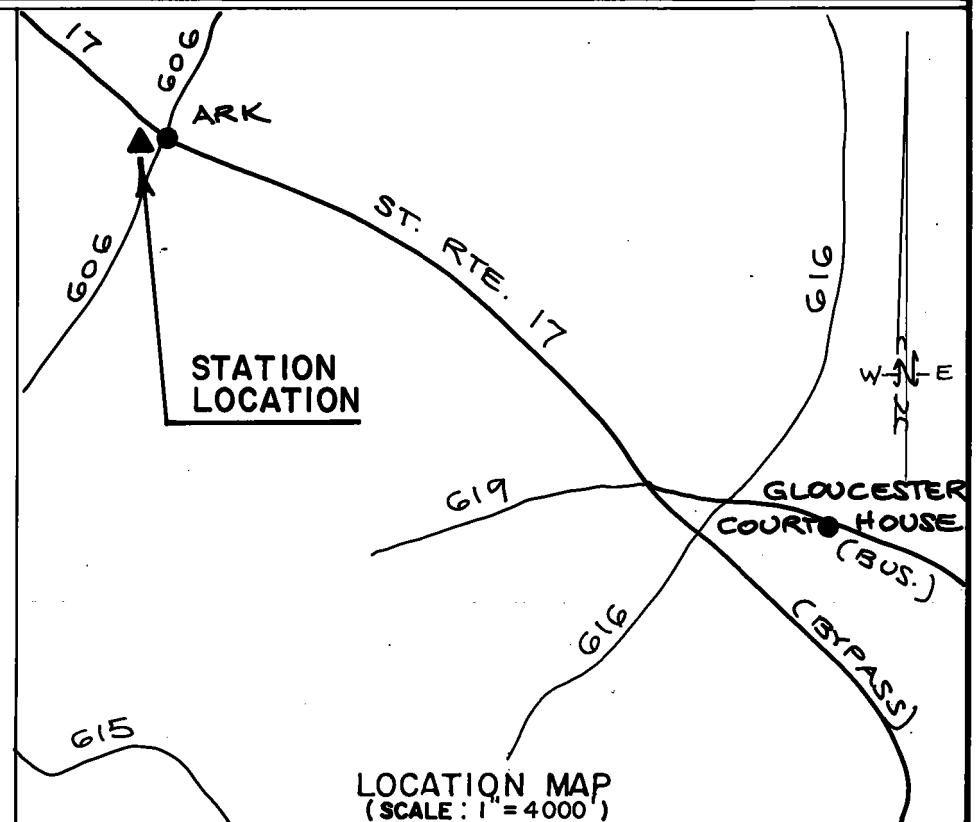

**LOCATION MAP**  
(SCALE: 1" = 4000')

DATE: JANUARY, 1992

NOTE: USERS OF MONUMENTS LOCATED ON PRIVATE PROPERTY  
MUST OBTAIN LAND OWNERS PERMISSION BEFORE ENTERING



**Dawson & Phillips, D.C.**

CERTIFIED LAND SURVEYORS  
(804) 693-2993