

GLOUCESTER COUNTY SURVEY MARK DATA SHEET

STATION NO.
115

HORIZONTAL DATA :		
VA. STATE PLANE COORD. - SOUTH ZONE (NAD 1983)		
UNITS	EASTING (X)	NORTHING (Y)
METERS	3680726.666	1120610.612
U.S. SURVEY FT.	12075850.737	3676536.650
LATITUDE (DMS)	37 24 9.18764	
LONGITUDE (DMS)	76 27 30.77443	
SCALE FACTOR	0.99994559	
CONVERGENCE \sphericalangle (DMS)	1 14 20.43	
VERTICAL DATA :		
REF. TO NATL. GEOD. VERT. DATUM (1988)		
UNITS	STATION ELEVATION	
METERS	3.38	
U.S. SURVEY FT.	11.08	

STATION DESCRIPTION :

DISTRICT : WARE

A 3-1/4" ALUMINUM DISK MONUMENT SET APPROXIMATELY FLUSH WITH THE GROUND STAMPED STATION NO. 115. TO REACH: FROM THE INTERSECTION OF STATE ROUTE 3 & 14 AND STATE ROUTE 623, GO ABOUT 2.6 MILES SOUTHEAST ON STATE ROUTE 623 TO INTERSECTION OF STATE 623 AND STATE ROUTE 692 AT WARE NECK POST OFFICE; MONUMENT SITE IS ON THE NORTH SIDE OF STATE ROUTE 623 AND THE EAST SIDE OF STATE ROUTE 692.

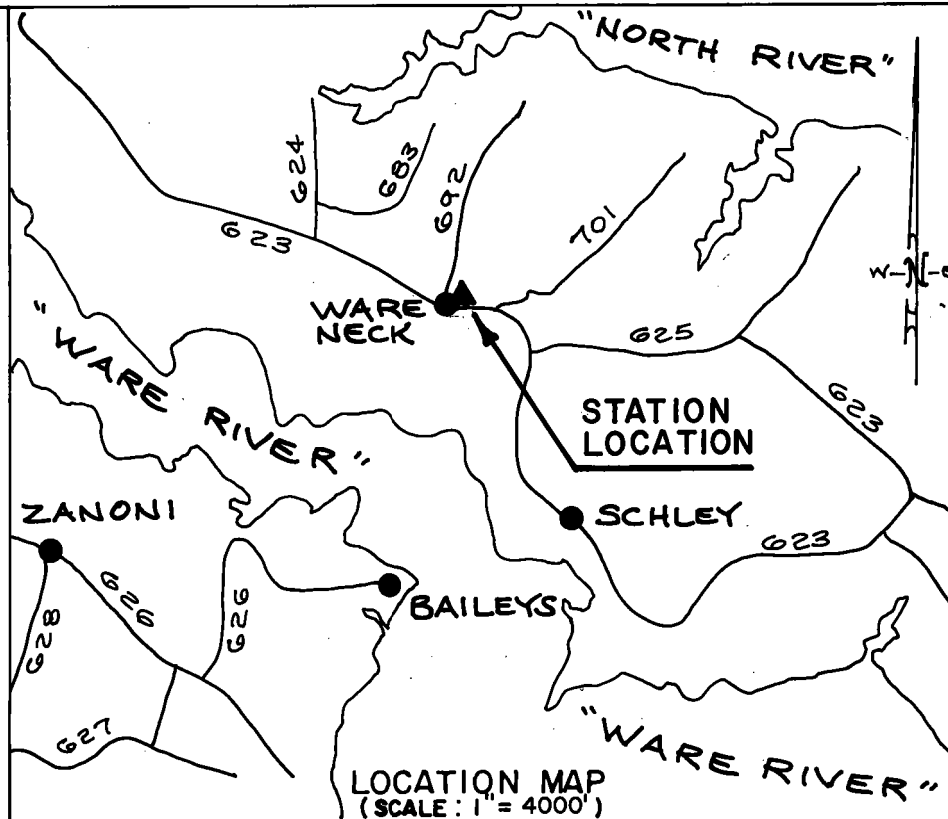
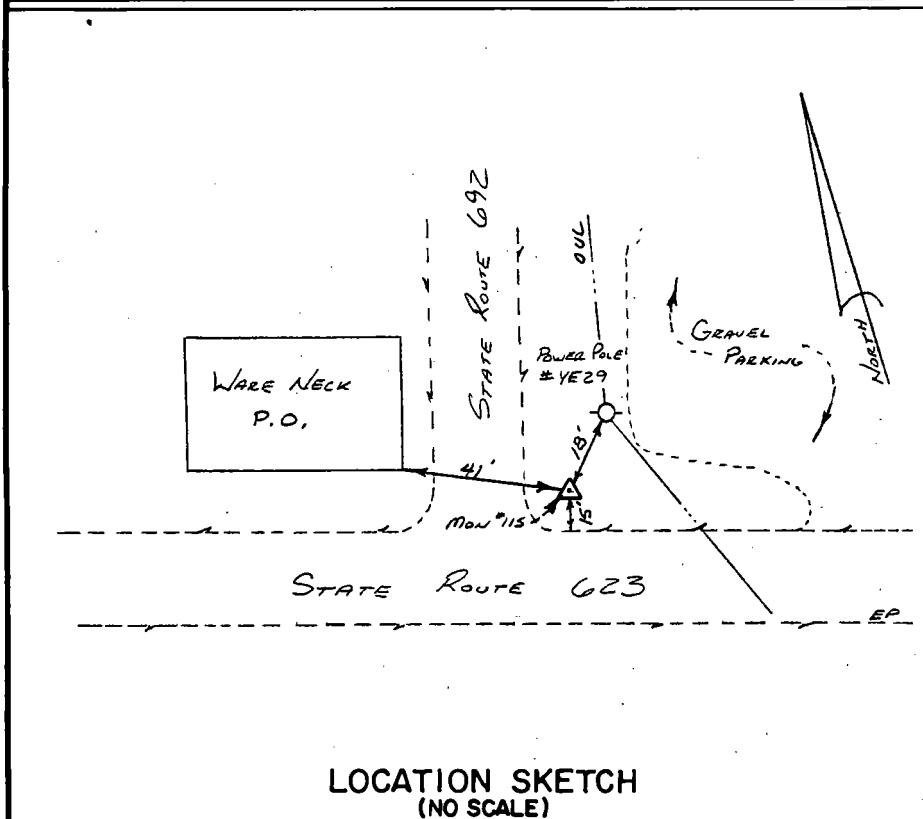

DATE: JANUARY, 1992

NOTE: USERS OF MONUMENTS LOCATED ON PRIVATE PROPERTY
MUST OBTAIN LAND OWNERS PERMISSION BEFORE ENTERING



DANSON & PHILLIPS, D.C.
CERTIFIED LAND SURVEYORS
(804) 693-2993