

GLOUCESTER COUNTY SURVEY MARK DATA SHEET

STATION NO.
120

HORIZONTAL DATA :

VA. STATE PLANE COORD. - SOUTH ZONE (NAD 1983)

UNITS	EASTING (X)	NORTHING (Y)
METERS	3676002.749	1127341.009
U.S. SURVEY FT.	12060352.352	3698617.960
LATITUDE (DMS)	37 27 50.73220	
LONGITUDE (DMS)	76 30 37.04663	
SCALE FACTOR	0.99994682	
CONVERGENCE α (DMS)	1 12 27.37	

STATION DESCRIPTION :

DISTRICT : WARE

A 3 1/4" ALUMINUM DISK MONUMENT SET APPROXIMATELY FLUSH WITH THE GROUND STAMPED STATION NO.120. TO REACH: FROM THE INTERSECTION OF STATE ROUTE 3 & 14 AND STATE ROUTE 605, GO ABOUT 3.3 MILES NORTH ON STATE ROUTE 605 TO PRIVATE LANE AND MONUMENT SITE. SITE IS ABOUT 0.3 MILE NORTH OF INTERSECTION OF STATE ROUTE 605 AND STATE ROUTE 603.

VERTICAL DATA :

REF. TO NATL. GEOD. VERT. DATUM (1988)

UNITS	STATION ELEVATION
METERS	26.33
U.S. SURVEY FT.	86.40

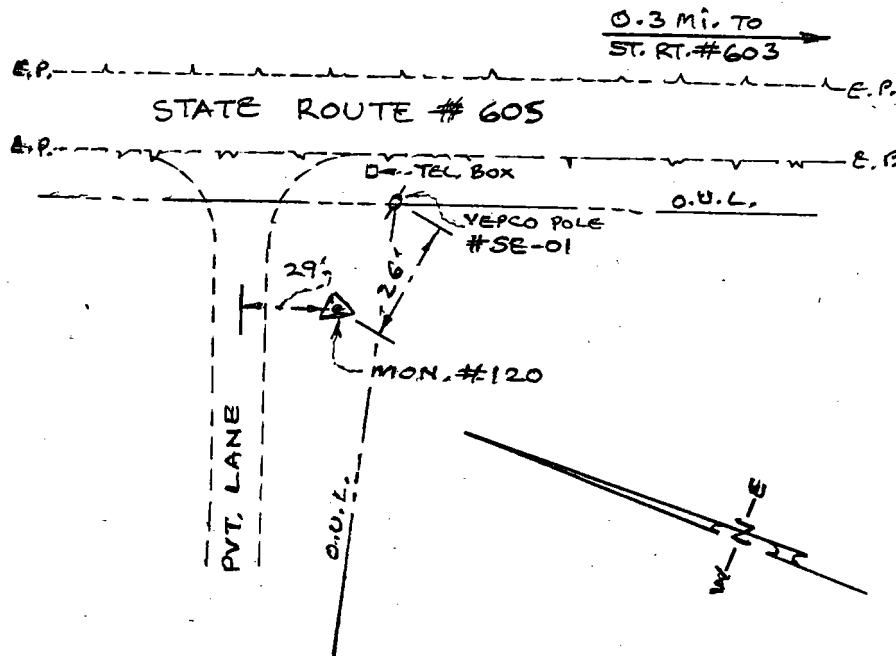

LOCATION SKETCH
(NO SCALE)

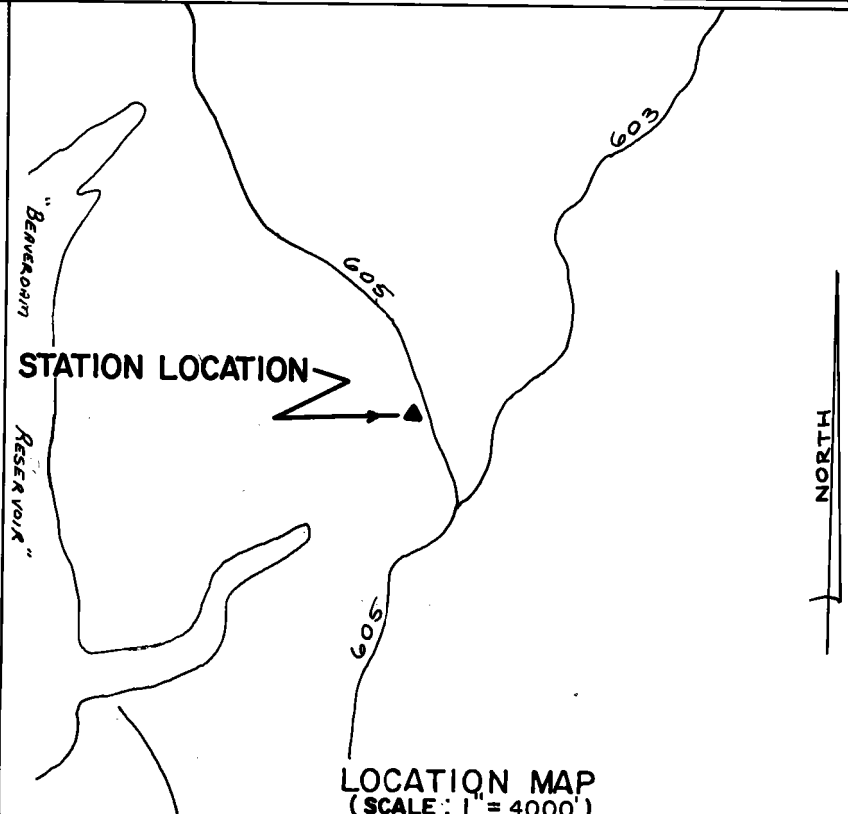

LOCATION MAP
(SCALE: 1" = 4000')

DATE: JANUARY, 1992

NOTE: USERS OF MONUMENTS LOCATED ON PRIVATE PROPERTY
MUST OBTAIN LAND OWNERS PERMISSION BEFORE ENTERING



DAWSON & PHILLIPS, D.C.

CERTIFIED LAND SURVEYORS
(804) 693-2993