

# GLOUCESTER COUNTY SURVEY MARK DATA SHEET

**STATION NO.**  
208

HORIZONTAL DATA :		
VA. STATE PLANE COORD. - SOUTH ZONE (NAD 1983)		
UNITS	EASTING (X)	NORTHING (Y)
METERS	3680773.003	1105041.237
U.S. SURVEY FT.	12076002.761	362456.125
LATITUDE (DMS)	37 15 44.21967	
LONGITUDE (DMS)	76 27 42.55786	
SCALE FACTOR	0.99994708	
CONVERGENCE $\sphericalangle$ (DMS)	1 14 13.28	
VERTICAL DATA :		
REF. TO NATL. GEOD. VERT. DATUM (1988)		
UNITS	STATION ELEVATION	
METERS	2.03	
U.S. SURVEY FT.	6.67	

**STATION DESCRIPTION :**

**DISTRICT :** YORK

A 3-1/4" ALUMINUM DISK MONUMENT SET APPROXIMATELY FLUSH WITH THE GROUND STAMPED STATION NO. 208. TO REACH: FROM THE INTERSECTION OF STATE ROUTE 216 AND STATE ROUTE 643 AT BENA, GO ABOUT 0.53 MILE SOUTHEAST ON STATE ROUTE 643 TO THE INTERSECTION OF STATE ROUTE 643 AND STATE ROUTE 638; GO ABOUT 0.6 MILE SOUTHWEST ON STATE ROUTE 638 TO MONUMENT SITE.

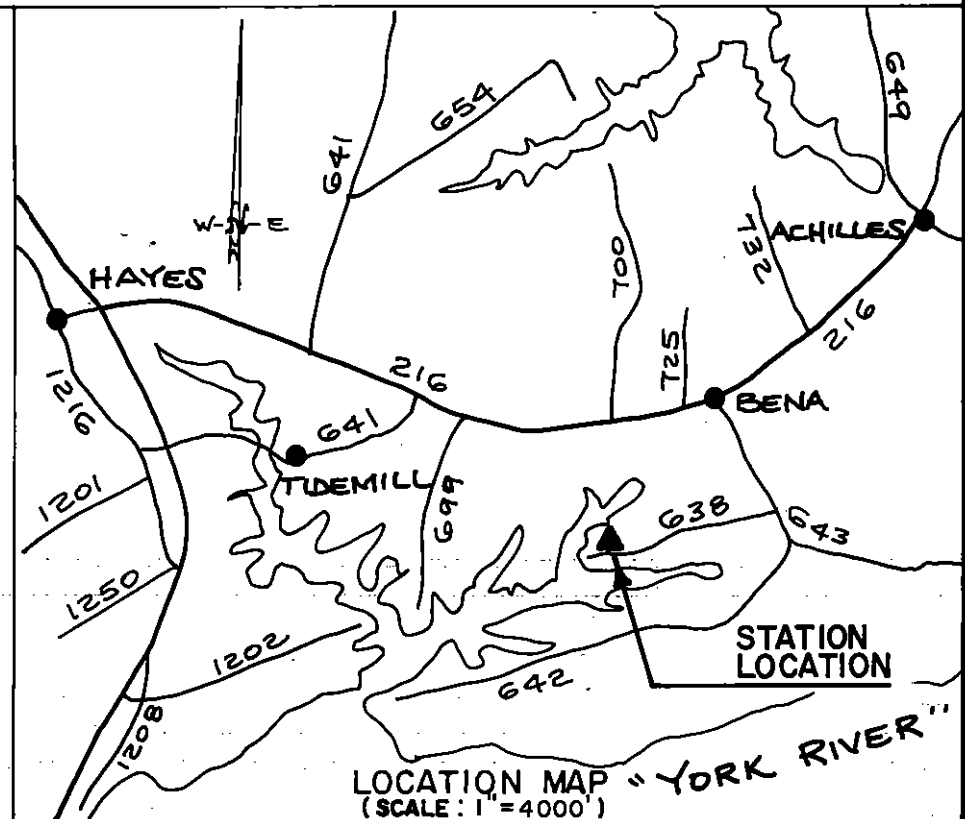
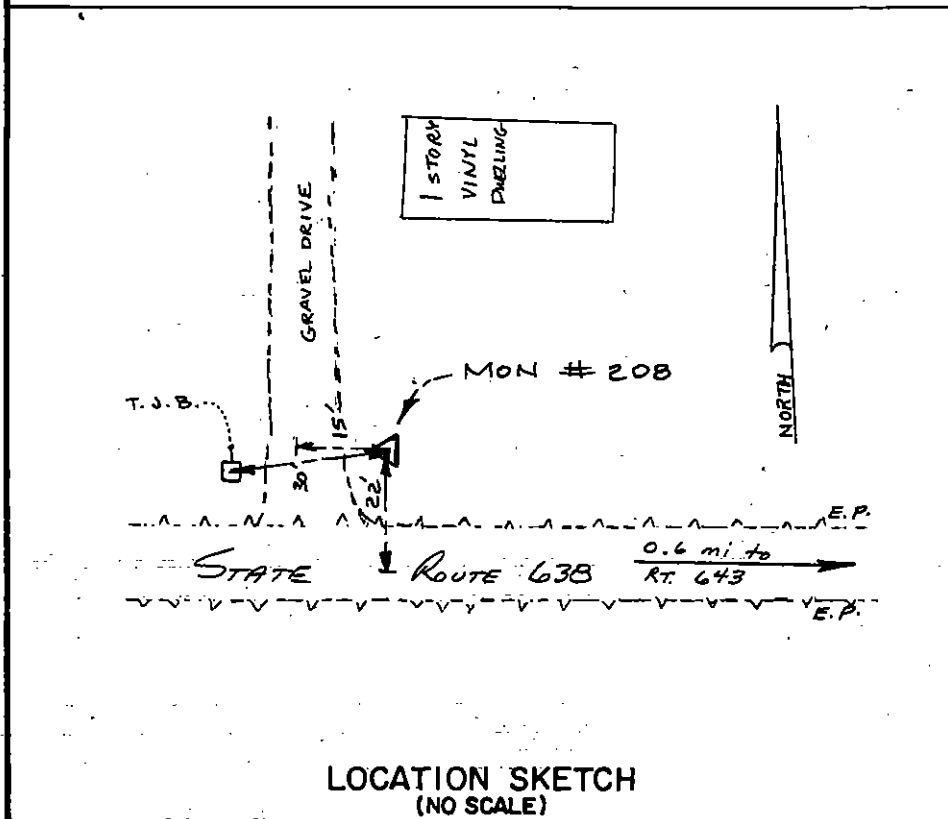

DATE: JANUARY, 1992

NOTE: USERS OF MONUMENTS LOCATED ON PRIVATE PROPERTY  
MUST OBTAIN LAND OWNERS PERMISSION BEFORE ENTERING



**DAWSON & PHILLIPS, P.C.**  
CERTIFIED LAND SURVEYORS  
(804) 693-2993