

GLOUCESTER COUNTY

13

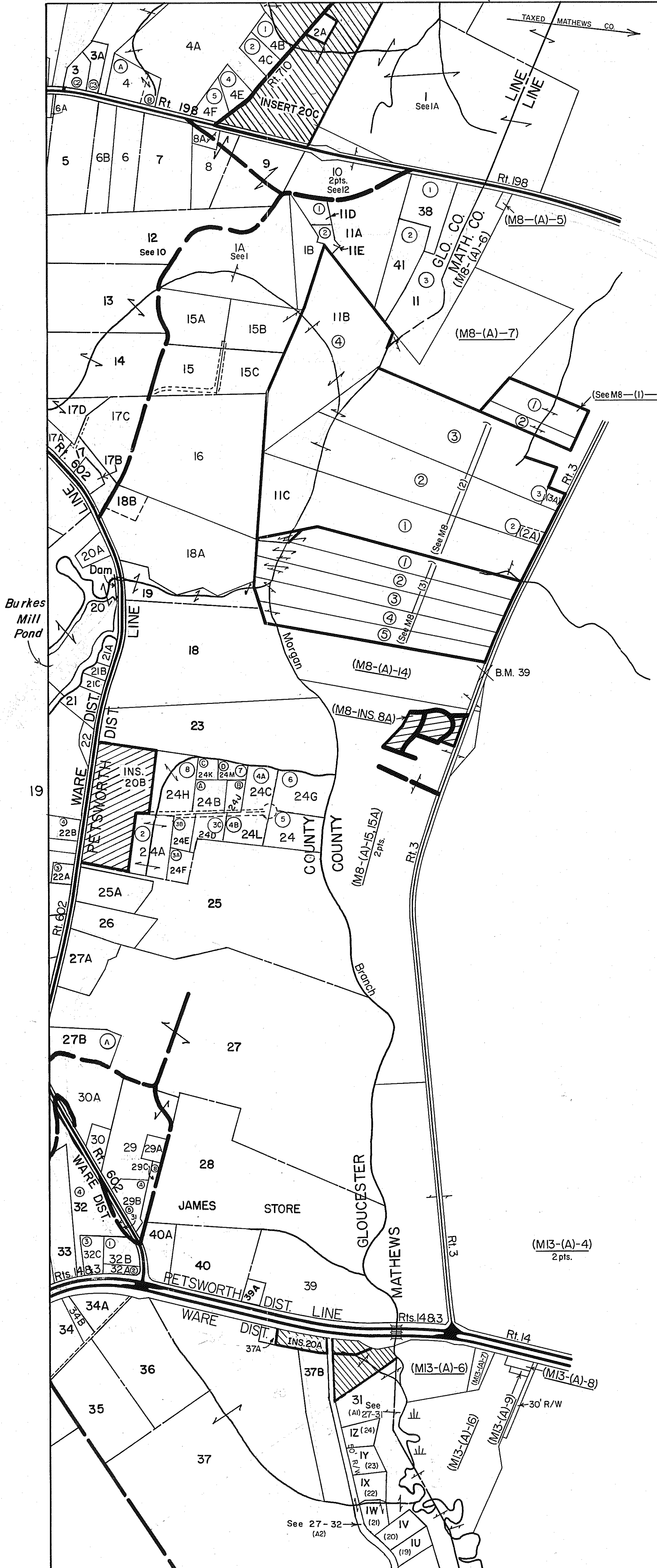

REV. 1/63 12/31/83/84/85/86/88/89/90/91/92/93/94/95/96/00/01/03/05/06/09/10  
 3/25/80, SCALE IN FEET  
 0 600 1200 1800 2400

27

WARE & PETSORTH DISTRICTS

VIRGINIA STATE DEPARTMENT OF TAXATION, DIVISION OF REAL ESTATE APPRAISAL AND MAPPING

SECTION 20