

GLOUCESTER COUNTY

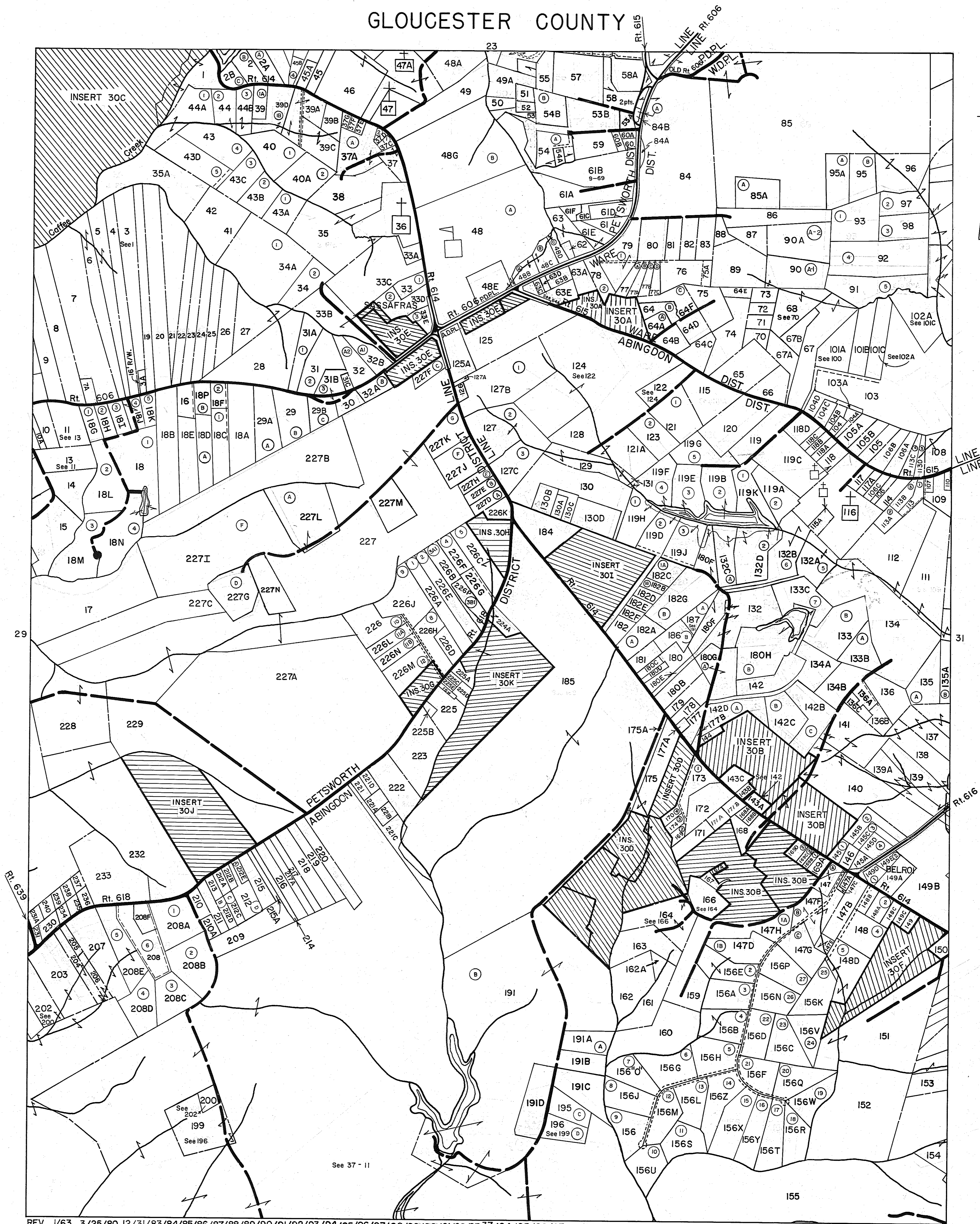

REV. 1/63 3/25/80, 12/31/83/84/85/86/87/88/89/90/91/92/93/94/95/96/97/98/99/00/01/02/03/37/04/05/06/07/08/09/10/11/12/13/14/16



ABINGDON, PETSWORTH & WARE DISTRICTS

SECTION 30

VIRGINIA STATE DEPARTMENT OF TAXATION, DIVISION OF REAL ESTATE APPRAISAL AND MAPPING