

GLOUCESTER COUNTY

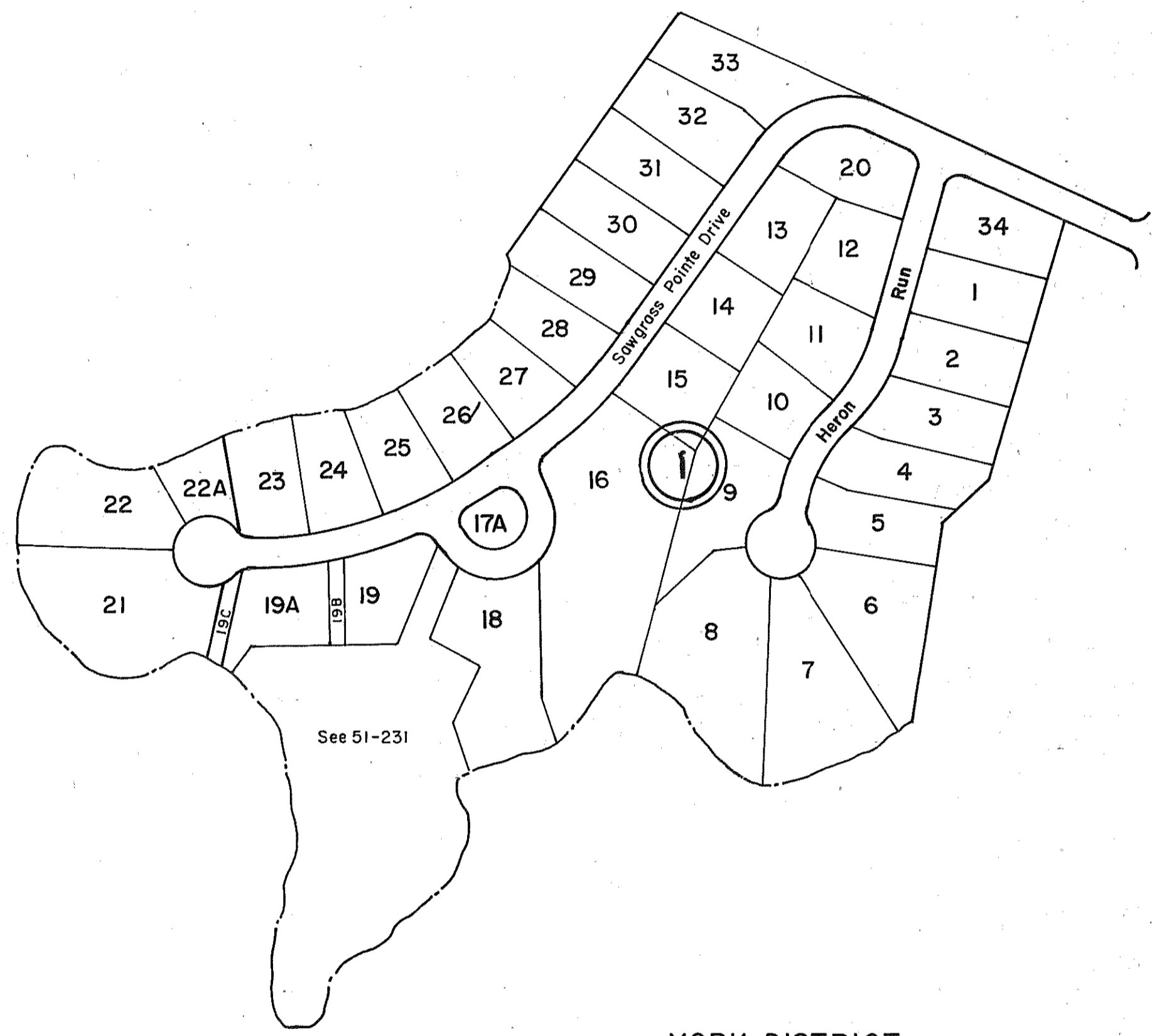

① SAWGRASS POINTE  
 LOTS 1-34  
 P.B. 21, Pg. 448, 6/87  
 LOTS 19B & 22A REVISED  
 P.B. 21, Pg. 720 4/1/88  
 LOTS 22A & 23-REVISED  
 P.D.B. 445, Pg. 627 5/6/93  
 LOT 17 - REVISED  
 P.B. 22, Pg. 1134 5/5/95

1" = 200'

YORK DISTRICT

5IV

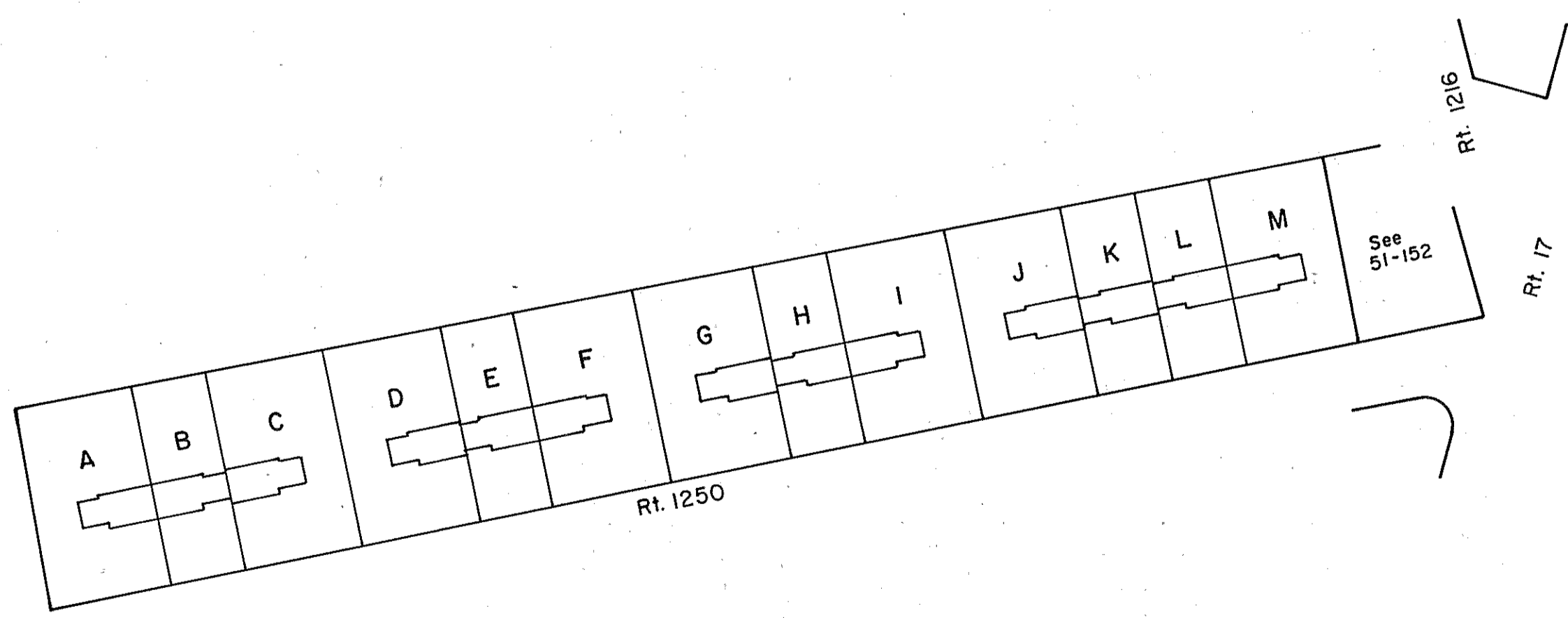

① INDIAN CROSSING  
 LOTS A-M, P.B. 21, Pgs. 46 & 46A, 4/8/86

1" = 100'

GLOUCESTER POINT DISTRICT

5IU

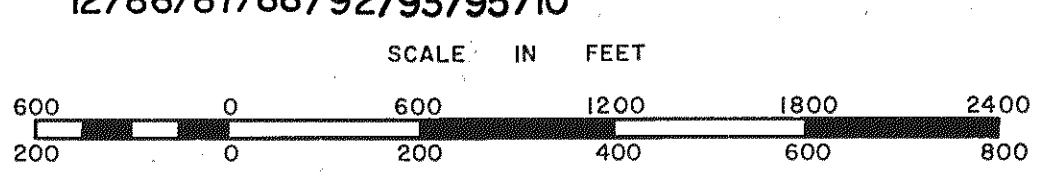

GLOUCESTER POINT  
 YORK DISTRICT

SECTION  
 INSERT 5IU,V